



# unOfficial Central Illinois Regional Guide

**FIRST Robotics Competition Team 1736, Robot Casserole**



www.robotcasserole.org  
FRC1736@gmail.com



<http://www.ilfirst.org/frc/events/central-illinois-regional/>

# 2019 Edition

# Table of Contents

Welcome	1
Communication and Important Events	1
Venue Information	2
Safety	5
Medical Emergencies	8
Local Media and CIR Webstream	9
East Peoria/Peoria Area Resources	10

## Welcome!

Greetings and salutations!

*FIRST*<sup>®</sup> Robotics Competition Team 1736 Robot Casserole welcomes you to the *FIRST*<sup>®</sup> Robotics Competition Central Illinois Regional. We offer you this guide to help you prepare for the competition March 14 through March 17, 2018.

We hope this guide proves to be useful to you during your stay at the *FIRST*<sup>®</sup> Robotics Competition Central Illinois Regional and we look forward to seeing you there!

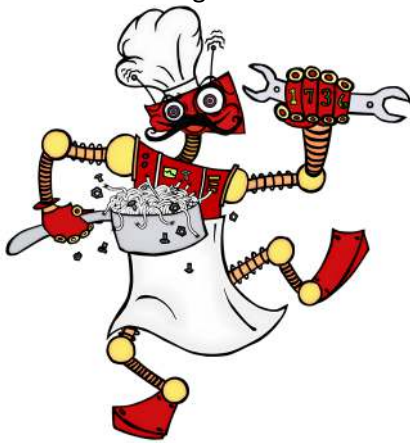

## Communication and Important Dates

Last-minute communication from the CIR Planning Committee is distributed via email blasts. Visit the CIR website to view all of the Email Blasts in one place: [Central Illinois Regional website](#).

Last updated January 16, 2019

3

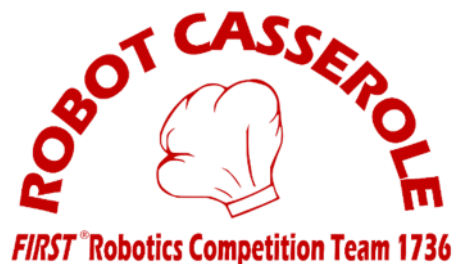



# Venue Information

Bradley University Renaissance Coliseum  
1600 W Main Street  
Peoria, IL 61606  
309-677-2677  
<http://www.bradley.edu/sites/coliseum/>

## General Directions

---

### From the St. Louis, IL area:

Traveling I-155 north, merge left onto Interstate 74 West toward Peoria. Final directions below.



### From the Chicago, IL area:

I-55 south to Bloomington/Normal. Take exit 163 for I-74 west toward Peoria. Final directions below.

### From the Beloit, WI/Western Chicago Suburbs area:

I-39/US-51 south to Bloomington/Normal. Keep right at the fork, follow signs for I-55 south/US-51 south/I-74/Peoria/Champaign. Merge onto I-55/US-51 south. Take exit 163 for I-74 west toward Peoria.

### All west-bound I-74 travelers:

Take Exit 91 for North University Street. Turn south (left) onto North University Street. Turn west (right) onto West Main Street. The Renaissance Center will be on the left.

### From the Davenport, IA/Moline, IL area:

Take Exit 91 for North University Street. Turn south (right) onto North University Street. Turn west (right) onto West Main Street. The Renaissance Center will be on the left.

If you are driving a car, the parking deck is next to the Coliseum. Turn onto Maplewood Avenue to access the parking deck.

**Flying in?** The nearest airport is General Wayne A. Downing Peoria International Airport (PIA)  
6100 W. Everett M. Dirksen Parkway, Peoria, IL [www.flypia.com](http://www.flypia.com)

## Venue Layout

---

The Renaissance Coliseum is a 165,200 square foot, multi-use athletic facility. The facility has many unique features such as the Zobrist Hospitality Room, the Braves Club Hospitality Suite, and the Burklund Family Heritage Hall & Bradley Athletics Hall of Fame. There are ample restrooms, concession stands, and meeting rooms for presentations.

The entire arena will be devoted to the competition playing field and the pits will be located in an attached practice gym area. Access to the pits for the robots is on the main floor; access to the pits for teams and the general public is on the Mezzanine level.

The arena is well-lit by banks of lights on both sides.





Free parking is available in the parking deck at the corner of Main and Maplewood, as well as limited parking on the street and around campus. Several campus lots require a parking sticker.

Additional venue information available at <https://www.bradley.edu/sites/coliseum/>

## Food and Drink at the Coliseum

---

There is a concession stand on the Mezzanine level of the Coliseum.

Box lunch and/or pizza options will be available from Bradley University. Information and the order form can be found at <https://www.bradley.edu/academic/continue/youth/robotics/>. Lunches ordered through Bradley University can be eaten in the Coliseum.

A food court is available in the Michel Student Center, which is a short walk from the Renaissance Coliseum and has Chick-fil-a Express, Moe's Southwestern Grill, Marketplace Deli, Tossed and the P.O.D. Market. Food purchased at the student center is considered food purchased through Bradley University and may be brought into the Coliseum.

**Outside food may not be brought into the Coliseum, the pit area, or the outside foyer areas of the Coliseum.** There are several restaurants within walking distance.

### Within Walking Distance on University Avenue/Campustown Shopping Center

- Bacci Pizzeria (Bradley Avenue)
- Avanti's Italian Restaurant
- Papa John's
- Pizza Hut
- One World Café (gluten free options)
- The Fieldhouse Bar & Grill
- McDonalds
- Jimmy Johns
- Subway
- Steak & Fries
- Panda House Carry Out
- Chai's Thai Cousine

Happy Fish Sushi  
Thanh Linh Vietnamese Restaurant  
Haddad's Restaurant  
Starbucks  
Broken Tree Coffee  
Las Delicias Mexican Ice Cream  
Thai Tyme Thai Cuisine  
Little Raven Eatery  
Harold's Chicken Shack #41

Western Avenue (to the west of Bradley University) - not as close

Domino's Pizza  
McDonald's  
Dunkin Donuts  
Kentucky Fried Chicken  
El Zarape



# Safety - Emergency Planning

*Think ahead, make a plan!*

Planning for travel safety has become a priority for *FIRST* Team 1736, Robot Casserole and we'd like to share our plan for the Central Illinois Regional with you so you can plan for safety, too!

## At the Renaissance Coliseum

---

### **Tornado**

In the event of a tornado, move to the basement of the Coliseum. (Basement stairs marked in blue on the map.) The stairwell access is from the Mezzanine level.

*Tip for making your plan:* Every team should have one or two mentors who have a complete list of every student and mentor at the event. Use this list to account for all of your team members during emergencies.

### **Fire/Evacuation**

In the event of fire, the most important thing you can do is remain calm and quiet so you can hear any announcements that are made. If asked to evacuate, proceed to the nearest outside exit and then go to your team meeting area. (Exits marked in yellow on the map.)

Fire extinguishers are located in the halls outside of the arena.

*Tip for making your plan:* Another component of your evacuation plan should include designating a meeting place outside the Coliseum for your team and equipping one or two mentors with a complete list of every student and mentor at the event so everyone can be accounted for.

Make sure you have reviewed your plans thoroughly with your team!

### **AED**

The AED is located on the Mezzanine level of the arena.

### **Construction Near the Coliseum**

Please refer to the map found at this link <https://www.bradley.edu/dotAsset/180548.pdf> regarding building demolition/construction. This may impact load/unload zones and street parking. Please read all email blasts for up-to-date information.

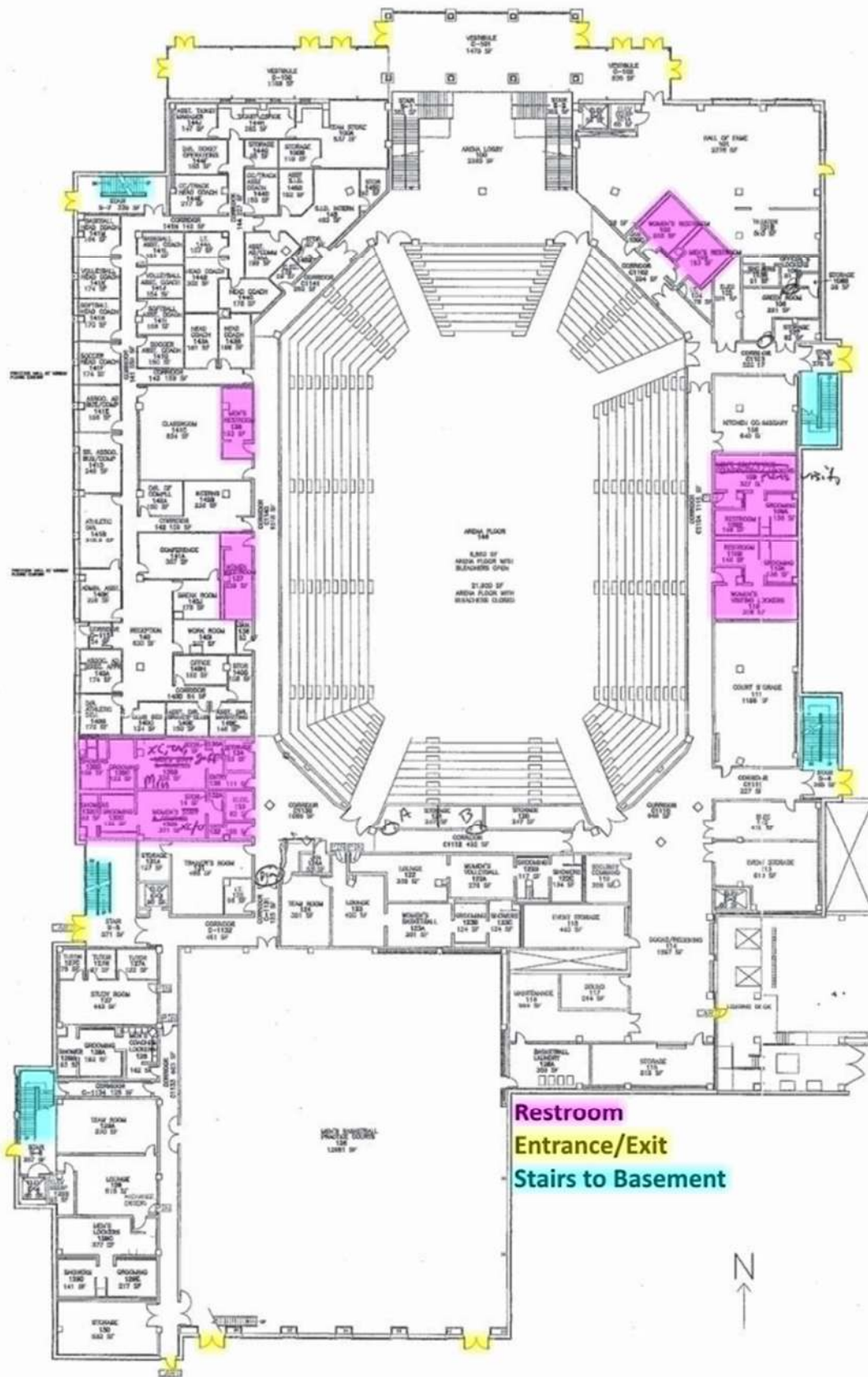

Restroom  
 Entrance/Exit  
 Stairs to Basement



Last

## At the Hotel

---

*Think ahead, make a plan.*

At the Wisconsin Regional in 2012, the fire alarm sounded in the middle of the night in the hotel where *FIRST* Team 1736 was staying. A lot of lessons were learned that night when we realized that (a) we didn't know if all of our team members were evacuated or were still in their rooms, and (b) if they evacuated, we didn't know where they all were or if they were with a mentor. Team members were unsure of where to go and what to do. Since that time, we make proactive plans for evacuations and tornados and hope we never have to use them.

We encourage each team to create their own Team Travel Emergency Procedures and invite you to use our documents as your starting place.

### *Tips for creating your plan:*

Contact the hotel where you will be staying to get answers to questions. You may need to speak to someone in security or to the manager. Be persistent if at first you don't succeed in finding the person who has the answers for you. Explain that you are making emergency plans for your team and most hotels will be most cooperative.

- In the event of a fire, is there an alarm that sounds?
  - Where are they? hallways? stairwells? lobby areas? each individual room?
  - What do they sound like?
  - If there is no alarm in the rooms, does the hotel call rooms to tell guests to evacuate?
- Do the rooms have windows that open in the event that the hallway is obstructed?
- Do they have a drawing of the hotel layout that they can send you? (Not totally necessary, but very helpful if you can get one.)
- Do you have a tornado warning or PA that announces an impending tornado? If not, how are guests notified of a tornado?
- Where is the safest place to gather in the event of a tornado?
  - If in a lower hallway, ask for the room number sequence in that hallway so you can direct your students where to gather in that hallway, if possible.

Using an online map resource, you can obtain an aerial view of the hotel where you are staying and map out a meeting place in the event of an evacuation. We drew arrows all over ours so students would know where the exits are and which way to go to get to the meeting place.

Designate one or more mentors to keep a list of student and mentor names and associated room numbers.

Establish a plan to determine whether students are still in their rooms or have evacuated. We use hang tags that say "evacuated" on the front

Last updated January 16, 2019



As an example,  
our [2013 Purdue Boilermaker plan](http://www.robotcasserole.org)  
is posted at [www.robotcasserole.org](http://www.robotcasserole.org)  
under the Resources/Safety Resources area.  
Feel free to use it  
as a guide for your own!

and list the students on the back. A very sticky Post-It note would work, too.

Be sure to review your plan thoroughly with the team members so everyone knows what to do!

## Medical Emergencies

### Peoria Area Medical Care

---

OSF Saint Francis Medical Center (hospital)  
(downtown Peoria area)  
530 NE Glen Oak Avenue, Peoria, IL  
309-655-2000

Unity Point Health – Methodist (hospital)  
(downtown Peoria area)  
221 NE Glen Oak Avenue, Peoria, IL  
309-672-5522

Unity Point Health - Proctor (hospital)  
(north Knoxville area)  
5409 N Knoxville Avenue, Peoria, IL  
309-691-1000

OSF Access Clinic (Formally Prompt Care)  
at Glen Park  
5114 N. Glen Park, Peoria, IL  
or Route 91 (North Peoria area)  
8600 Illinois Rt. 91, Peoria, IL  
309-655-2431 (for both locations)  
M-Sat 8:00 a.m. - 7 p.m., Sun 8:00 a.m. – 5 p.m.

Proctor First Care – Barring Trace  
(northwest Peoria/Willow Knolls area)  
3915 W Barring Trace, Peoria, IL  
309-689-3030  
M-Sat 8:00 a.m. - 10:00 p.m.

Proctor First Care – Peoria Heights  
1120 E War Memorial Drive, Peoria Heights, IL  
309-685-4411  
M-F 8:00 a.m. - 6 p.m., Sat. 9:00 a.m. - 4 p.m.

Unity Point Clinic Express Care  
(northeast area/Knoxville Ave)  
8914 N Knoxville Avenue, Peoria, IL  
309-691-9110

## East Peoria Area Medical Care

---

Nearest Hospitals (downtown Peoria area\*):

OSF Saint Francis Medical Center\*  
530 NE Glen Oak Avenue, Peoria, IL  
309-655-2000

Unity Point Health Methodist\*  
221 NE Glen Oak Avenue, Peoria, IL  
309-672-5522

Proctor First Care  
2535 E Washington Street, East Peoria, IL  
309-694-6464  
M-F 8:00 a.m. - 6:00 p.m.

## Local Media

*FIRST* events always make the news, and sometimes your team is featured! Here is a list of the local media so you'll know where to look.

### Television Stations

---

WHOI Channel 19	<a href="http://www.cinewsnow.com">www.cinewsnow.com</a>	309-698-2525
WEEK News 25	<a href="http://www.cinewsnow.com">www.cinewsnow.com</a>	309-698-2525
WMBD/WYZZ News 31	<a href="http://www.centralillinoisproud.com">www.centralillinoisproud.com</a>	309-688-3131
WAOE Channel 59	<a href="http://my59.tv">my59.tv</a>	309-674-5900
BUTV News	<a href="http://com.bradley.edu/butvnews/">http://com.bradley.edu/butvnews/</a>	

### Newspapers

---

Pekin Daily Times	<a href="http://www.pekintimes.com">www.pekintimes.com</a>	309-346-1111
Morton Times-News	<a href="http://www.mortontimesnews.com">www.mortontimesnews.com</a>	309-263-2211
Morton Courier	<a href="http://www.courierpapers.com">www.courierpapers.com</a>	309-444-3139
Peoria Journal Star	<a href="http://www.pjstar.com">www.pjstar.com</a>	309-686-3000
East Peoria Times-Courier	<a href="http://www.eastpeoriatimescourier.com">www.eastpeoriatimescourier.com</a>	309-692-6600
Bloomington Pantagraph	<a href="http://www.pantagraph.com">www.pantagraph.com</a>	309-829-9000
Washington Courier	<a href="http://www.courierpapers.com">www.courierpapers.com</a>	309-444-3139
Washington Times-Reporter	<a href="http://www.washingtontimesreporter.com">www.washingtontimesreporter.com</a>	309-686-3054
Woodford Courier	<a href="http://www.courierpapers.com">www.courierpapers.com</a>	309-44403139

### Central Illinois Regional Webstream

---

Can't make it to the competition? Watch it live via the webstream at <http://www.ilfirst.org>.

# East Peoria/Peoria Area Resources

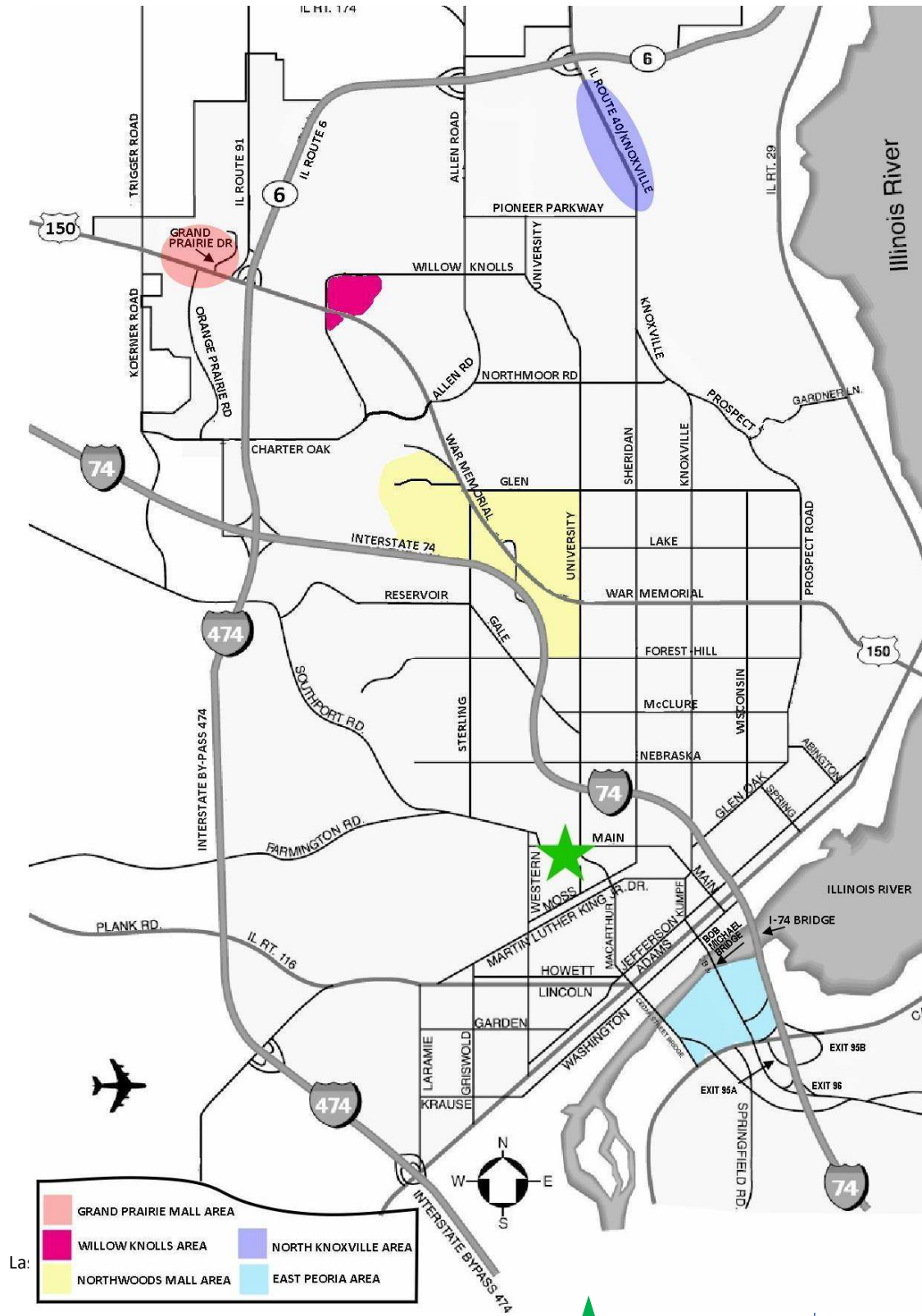

Bradley University Area



## Hardware/Parts/Electronics Stores

---

### Lowe's

201 Riverside Drive, East Peoria, IL  
309-694-0774

### Sutherland Ace Hardware

2244 E Washington Street, East Peoria, IL  
309-694-3465

### Tim's Ace Hardware

120 W McClure Avenue, Peoria, IL  
309-685-2613

### Tim's Ace Hardware

8903 N Knoxville Avenue, Peoria, IL  
309-689-1133

### Lowe's

5001 N Big Hollow Road, Peoria, IL  
309-692-1900

### Home Depot

5026 West Holiday Drive, Peoria, IL  
309-693-3819

### Menards

2627 W Townline Road, Peoria, IL  
309-693-0416

### Best Buy

5001 N Big Hollow Road, Peoria, IL  
309-689-0277

### Nena True Value Hardware

1415 W Forrest Hill Avenue, Peoria, IL  
309-688-9700

## General Merchandise Stores

---

### Dollar Tree (by Bradley University)

1200 W Main, Peoria, IL  
309-494-6509

### East Peoria Walmart Supercenter Store

401 River Road, East Peoria, IL  
309-694-0513

### Target

480 W Washington Street, East Peoria, IL  
309-407-3045

### Walmart

3315 N University Street, Peoria, IL  
309-682-0055

### Walmart Supercenter

8915 N Allen Road, Peoria, IL  
309-693-0525

### Target

5001 N Big Hollow Road, Peoria, IL  
309-691-9030

## Office Supply Stores/Hobby Stores

---

Office Depot  
200 Riverside Drive, East Peoria, IL  
309-698-9811

Hobby Lobby  
3433 N University Street, Peoria, IL  
309-686-4058

Office Depot  
4100 W Willow Knolls Dr., Peoria, IL  
309-691-3300

## Grocery Stores

---

Kroger  
201 S Main Street, East Peoria, IL

Kroger (N Knoxville area)  
9219 N Lindbergh Drive, Peoria, IL

Aldi  
251 Clock Tower Dr, East Peoria, IL

Schnucks (Northwoods Mall area)  
4800 N University Avenue, Peoria, IL

Kroger (Northwoods Mall area)  
3311 N Sterling Avenue, Peoria, IL  
801 W Lake Avenue, Peoria, IL

HyVee (Northwoods Mall area)  
4125 N Sheridan Road, Peoria, IL

Hy-Vee (Grand Prairie Mall area)  
7610 N Orange Prairie Rd, Peoria, IL

## Drug Stores

---

CVS (by Bradley University)  
1200 W Main Street, Peoria, IL  
309-673-6272

Walgreens  
2515 N Knoxville Avenue, Peoria, IL  
309-685-2012

Walgreens  
300 N Main Street, East Peoria, IL  
309-694-7661

CVS (North Knoxville Ave area)  
9315 N Lindbergh Drive, Peoria, IL  
309-691-7738

CVS  
200 N. Main Street, East Peoria, IL  
309-694-1496

CVS (Grand Prairie/Willow Knolls area)  
6820 N Pear Tree Lane, Peoria, IL  
309-689-1873

Walgreens (Northwoods Mall area)  
2324 W War Memorial Drive, Peoria, IL  
309-685-5209



## Restaurants

---

*This list is provided for informational purposes only; no endorsements or recommendations are implied. Restaurants are grouped by areas (see map on page 11).*

### **Outside food and drink is prohibited in Coliseum.**

#### **Bradley University Area**

Chick-Fil-a Express (Student Center)	Panda House Carry Out
Bacci Pizzeria (Bradley Avenue)	Bellacino's Pizza & Grinders
Avanti's Italian Restaurant	Pizza Hut
One World Cafe	Subway
McDonalds	The Fieldhouse
Chicky Baba	The Great Wall
Jimmy Johns	Happy Fish Sushi
Steak & Fries	Starbucks

**East Peoria Area** (Fairfield Inn/Holiday Inn & Suites) (East Peoria restaurants are also very close to downtown Peoria (Marriott Pere Marquette))

McDonald's	Red Robin
Hardees	Firehouse Pizza
Steak & Shake	Buffalo Wild Wings
Arby's	Applebee's
Taco Bell	Chili's
Jimmy Johns	Pho Noodle House
Subway (in Walmart)	Shogun Japanese Restaurant
Chick-fil-a	Lorena's Mexican Restaurant
Culver's	Bob Evans
Panera	IHOP Restaurant
Qdoba Mexican Grill	Logan's Roadhouse
Chipotle	Johnny's Italian Steakhouse
Moe's Southwest Grill	Granite City Food & Brewery
Potbellies	Texas Roadhouse
Jersey Mike's Subs	Papa John's Pizza
Jason's Deli	Pizza Hut to Go
Slim Chickens	Starbuck's (in Target)
Noodles & Co.	
Panda Express	

Downtown Peoria (Marriott Pere Marquette)

Downtown eateries do not have accommodations for large teams.

**Northwoods Mall Area/Central Peoria** (Quality Inn/Courtyard)

Off University Avenue

Steak & Shake  
Golden Corral  
McDonalds  
Hardees  
Burger King  
Koury's Cuisine  
Culvers  
McAlister's Deli  
Wingstop  
Qdoba Mexican Grill  
Chili's  
Starbucks  
Subway  
Fish House  
Noodles & Company (MetroCentre)  
Pregame (MetroCentre)  
Jimmy John's (MetroCentre)  
Nick & Willie's Pizza (MetroCentre)  
50's Diner (MetroCenter)  
Jalapeno's Mexican (MetroCentre)  
Penn Station (MetroCentre)

Off War Memorial

Perkins  
Pizza Ranch  
Mariachi's  
Smo-King Pit (in the mall)  
Panda Express  
McDonald's

Off Sterling Avenue

Arby's  
Sonic Drive-in  
5 Guys Burgers and Fries  
Biaggi's  
Panera  
Chick-Fil-a  
Chipotle Mexican Grill  
Red Lobster  
Sterling Diner  
Firehouse Subs

Off Big Hollow Road

Avanti's Ristorante  
Steak & Shake  
IHOP  
Wendy's  
Core Life Eatery

Off Glen Avenue

Lariat Steakhouse  
Kentucky Fried Chicken  
Popeye's Chicken  
Spotted Cow  
Marco's Pizza

**Willow Knolls Area** (off War Memorial, south of Country Inn & Suites)

Arby's  
McDonalds  
Hardees  
Olive Garden  
Applebees  
Monicals Pizza

**Grand Prairie Area** (Country Inn & Suites)

Culver's  
Hickory River Smokehouse  
TGI Fridays  
Long Horn Steakhouse  
Famous Dave's  
Starbucks  
Steak & Shake  
DQ Brazier

Old Chicago Pizza  
Osaka Hibachi & Sushi Bar  
Good Tequila's

Flat Top Grill  
Buffalo Wild Wings

**North Knoxville Avenue Area** (AmericInn)

Jimmy John's  
DQ Brazier  
Avanti's Ristorante  
Taco Bell

Hardees  
Firehouse Pizza  
Subway  
Panera Bread